

The Old Country Inn

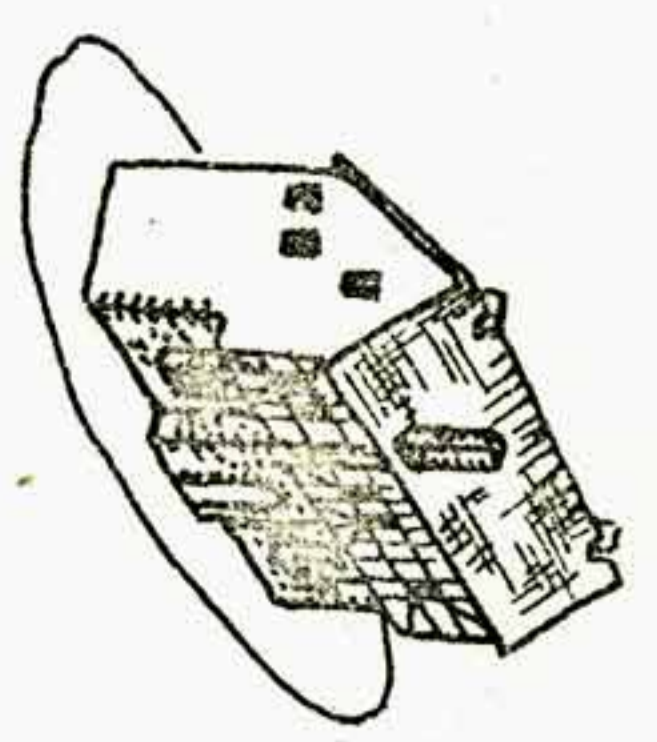

A must for any wargame (1600-1980)
 - a place for the troops to rest and
 be merry.

INSTRUCTIONS:

- ① Glue sheets onto light card.
 - ② Score with knife where each fold to be made.
 - ③ Cut out pieces and fold and glue into shape.
 - ④ Paint - Use light wash
- Roof: Red, Brown or Grey.
 Brickwork: Red
 Walls: Cream or White
 Doors: Green
 Window Surrounds: Grey

(Extra copies available from club shop)

Forward section of front wall.

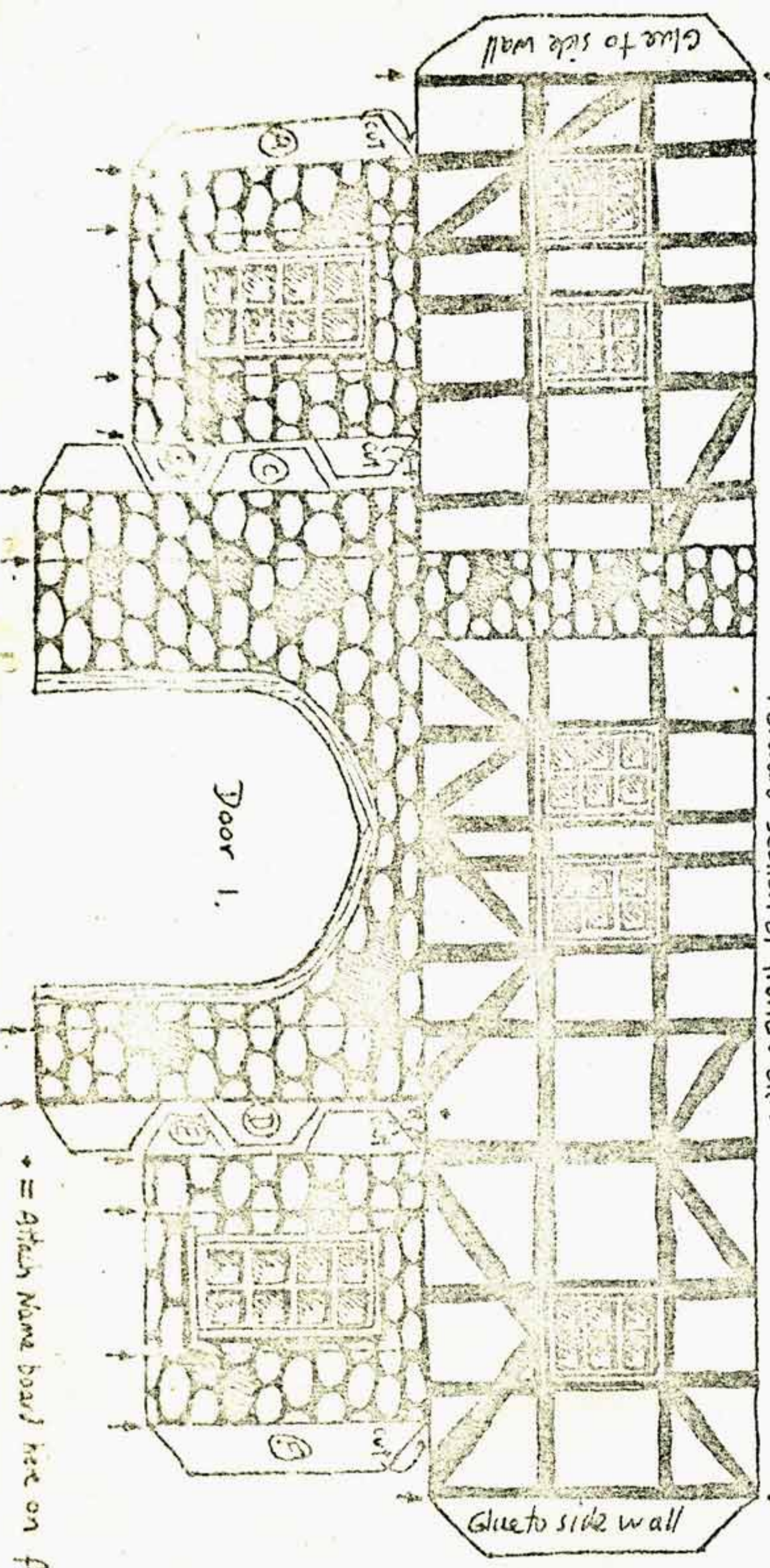

Front Wall

